

CASTLE HILL

about 5½ miles from Parramatta
Tram passes within a few yards of Estate

PORTION
OF

SOUTHLEIGH ESTATE

AUCTION SALE ON THE GROUND

SAT. 23RD SEPTEMBER 1922 AT 3 P.M.

PERCY C. SHARPE

Auctioneer 107 Pitt St Sydney.

Lots sold Average from

13/6 to 16/- p/p

38 allotments about half an acre each.

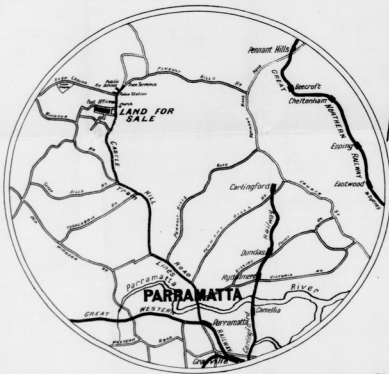
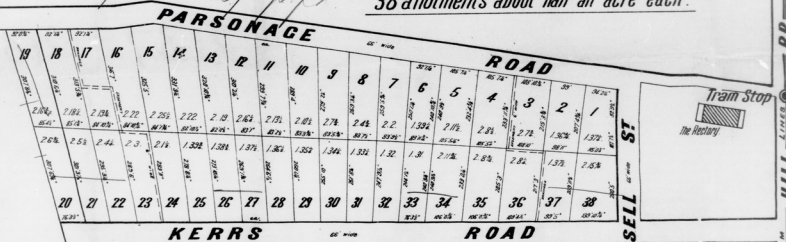

WM. A. CHADWICK

Licensed Surveyor R.P.A.C.
"Ocean House", Martin Place, City.

TERMS

£5 deposit per lot, balance
by quarterly instalments extending
over 3 years. Interest 6 per cent.

TORRENS TITLE

All measurements subject to Deposited Plan

C13/12

S. D. Townsend & Co., Printers, 117 Bathurst Street, Sydney.