

BONNIE VIEW ESTATE BAULKHAM HILLS

A Subdivision of 15 beautiful lots, suitable for Speculators, Investors and Home Seekers, only 22 miles from Sydney by splendid concrete & macadamised roads, and the alternate tourist route to North Sydney. On the Main New Windsor Rd & Showground Road, Baulkham Hills. The land is well elevated & drained, & every lot has a beautiful outlook over all the surrounding district. Lots 1 to 6 have unsurpassed views of the Blue Mountains, fruit trees on each block. Lot 1 has a large dam and shelter sheds and is especially suitable for shops & refreshment rooms as hundreds of tourists pass the corner on week-ends.

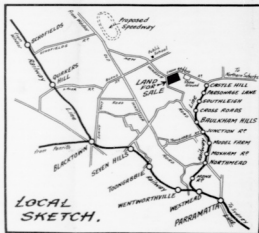

View of orchard on Estate looking North



LOCAL SKETCH.



View from Estate looking East

FOR PRIVATE SALE BY "MACCORMICK ESTATES"

"Rickard House," 84 Pitt St, Sydney. Telephone .B. 4409.

**ATTRACTIVE
PROPERTY**

*Splendid Soil,
will grow anything.*

**ATTRACTIVE
TERMS**

*Nominal Deposit,
Balance in 5 years by
quarterly instalments,
Interest 6 per cent.*

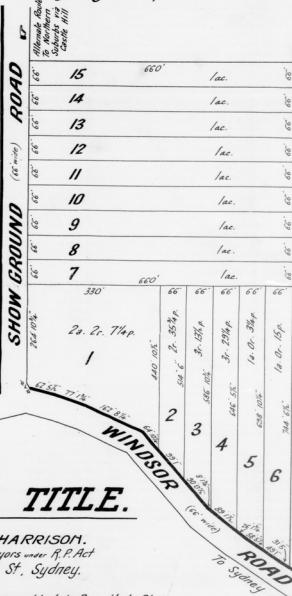

NEW
From Windsor

TORRENS TITLE.

GRIFFIN & HARRISON,
Licensed Surveyors under R.P. Act
350 George St, Sydney.

All Dimensions & Areas are subject to Deposited Plan.

B9/23