

E.J. - EXPANSION JOINT (FULL DEPTH OF CONCRETE).
 C.J. - CONTRACTION JOINT.

PLAN

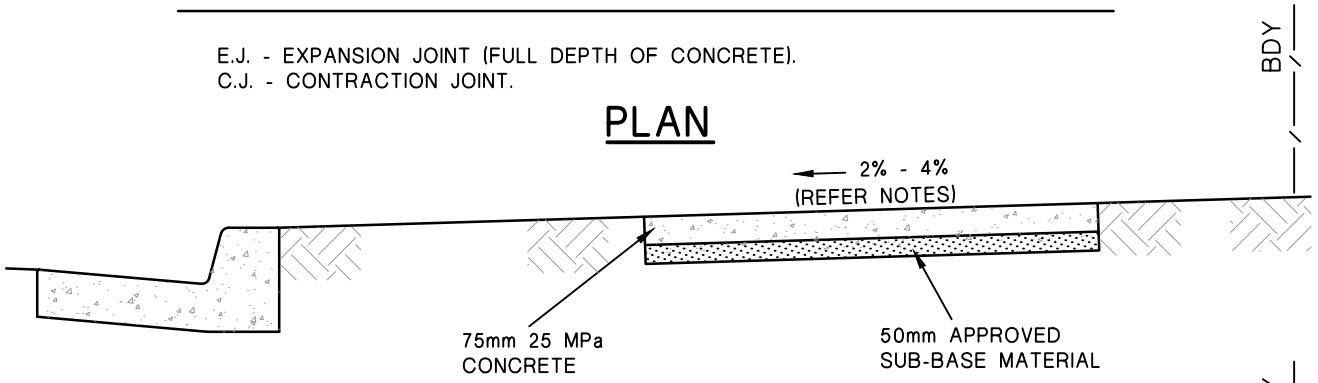

TYPICAL SECTION - INFILL

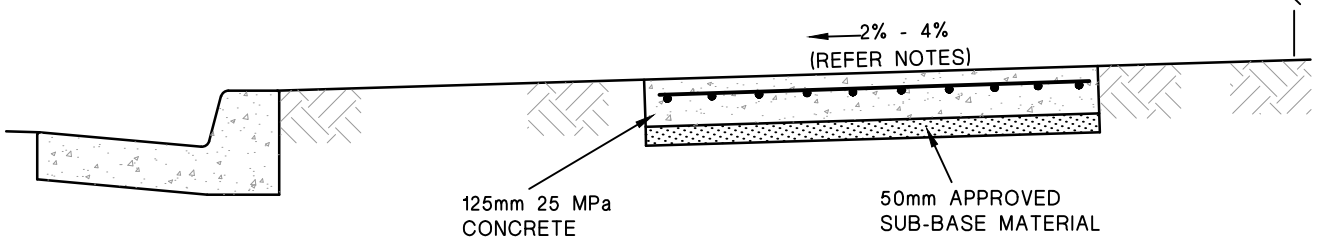

TYPICAL SECTION - DRIVEWAYS AND NEW DEVELOPMENT

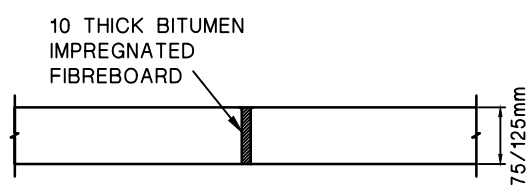

EXPANSION JOINT
 AT 6000 MAX. INTERVALS

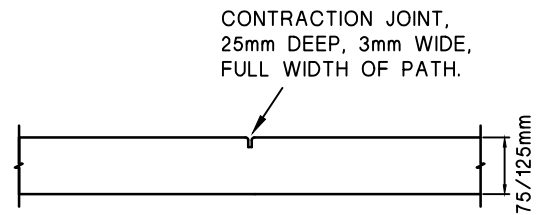

TRANSVERSE CONTRACTION JOINT
 AT 1500 MAX. SPACING

NOTES

1. ALL DIMENSIONS ARE IN MILLIMETRES.
2. ACTUAL WIDTH OF FOOTPATH PAVING SHALL BE SPECIFIED BY COUNCIL (MINIMUM 1.2m AND MAXIMUM 1.5m).
3. MINIMUM CONCRETE STRENGTH SHALL BE 25MPa.
4. RAMP TO BE PROVIDED WITH NON SLIP (BROOM) FINISH.
5. PREFERRED CROSSFALL SHALL BE 2.5%.
6. WHERE CONSTRUCTED ADJACENT TO VACANT LAND/NEW DEVELOPMENT OR ROLL KERB, INCREASE CONCRETE DEPTH TO 125mm AND INCLUDE F72 MESH (MINIMUM).
7. WHERE CONSTRUCTED AT AN EXISTING DRIVEWAY, INCREASE CONCRETE DEPTH TO 125mm AND INCLUDE F72 MESH (MINIMUM) EXTENDING 1.5m ON EACH SIDE OF THE DRIVEWAY.
8. ALL EXPOSED CONCRETE EDGES TO BE ROUNDED TO A 5mm RADIUS.

	THE HILLS SHIRE COUNCIL	DATE: SEPT. 2020
	FOOTPATH PAVING AND JOINTING DETAILS	DRAWING No.: SD.18